

DUALTRON

AMINIA

Personal Mobility

PRODUCT MANUAL

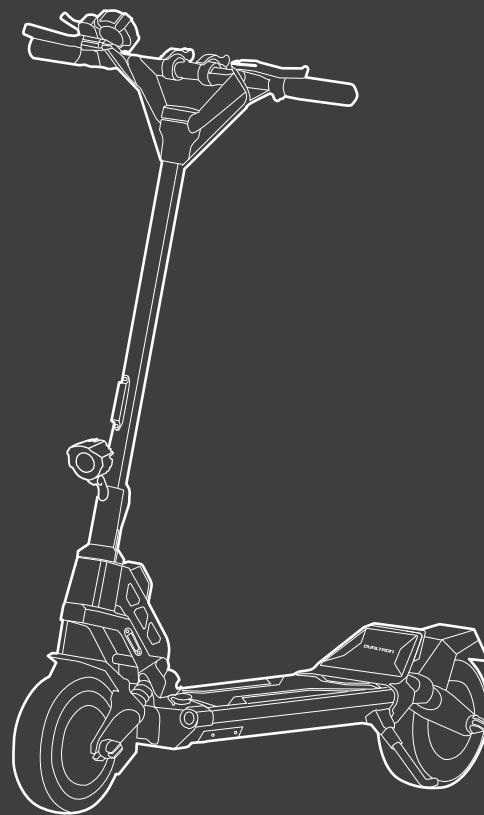

RECICLA
RECYCLE





Scan the QR code to download the latest user materials
and obtain the latest updates and safety instructions.

DUALTRON

The dream of electric technology.

The pictures shown are for illustration purposes only. Actual product may vary.

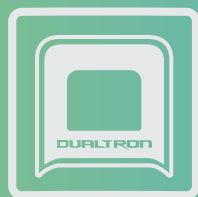





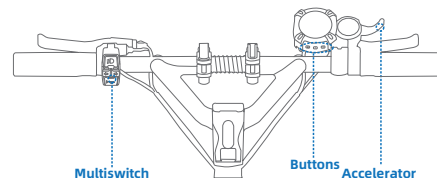
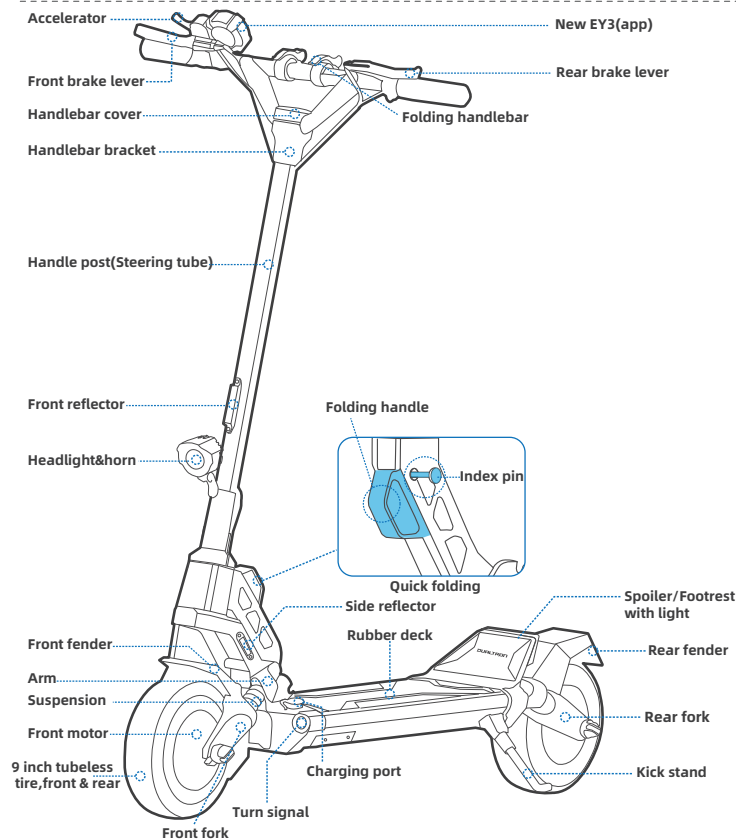

MINIMOTORS

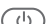

Diagram And Functions



Name	Function	Operation method
 Headlight button	Turn on/off headlight	Press the light button, turn on/off the headlight.
 Turn Signal Button	Turn on/off the left/right signal	Press the left/right side of the Turn Signal Button, the left/right turn signal will keep blinking.
 Horn Button	Turn on the horn	Press the Horn Button, the scooter will beep once.
 Power button	Turn on/off power	1.Press and hold the Power button to turn on/off the scooter. 2.Press the button to adjust the speed gear.
 Set button	Settings	1.Press and hold the Set button to enter/exit ECO mode. 2.Press the button to switch battery voltage/percent indication
 Mode button	Mode selection	1.Press and hold the Mode button to enter/exit the mode setting,and automatically return to the main interface after 30s. 2.Press the the Mode button to switch TRIP/RANGE/ODO .
 Accelerator	Speed up	Pull the throttle to accelerate.



Specifications

	Item	Parameter	
Product	Model	Dualtron Aminia Special (Single motor)	Dualtron Aminia Long Body(Dual motor)
Battery	Battery Capacity	52V13Ah / 52V17.5Ah (Samsung)	52V15.6Ah / 52V21Ah (Samsung)
	Range	46km / 60km	50km / 65km
	Charging Ambient Temperature	0 to 40°C (Battery temperature exceeds 55°C,BMS start protection program.)	
	Battery Management System	Over-heating, short circuit, over-current, over-discharge and over-charge protection	
Rider	Max. load	120kg	
	Recommended Age	16-60 years old	
	Required Height	3'11" -6'6" (120-200 cm)	
Display	Type	New EY3 display(DUALTRON APP available)	
Motor	Motor Type	BLDC Hub Motor	
	Nominal Power	900W	900W*2
Machine	Net Weight	Around 25.6kg	Around 30kg
	Max. Slope	Around 26.8%(15°Single-wheel drive)	Around 46.6%(25°Two-wheel drive)
	Drive System	Single motor drive	Dual motor drive
	Speed	25km/h	
	Length × Width × Height	1160×620×1190mm	1250×620×1200mm
	Folded: Length × Width × Height	1240×270×380mm	1255×270×380mm
	Wheelbase	Approx.895mm	Approx.940mm
	Ground Clearance	Approx.110mm	Approx.110mm
	Traversable Terrain	Asphalt/flat pavement; obstacles < 5 cm; gaps < 5 cm	
	Operating Temperature	-5 to 45°C	
	Storage Temperature	-20 to 50°C	



Specifications

IP Rating	Entire Vehicle	IP55
Brake	Machine Brake	Front & rear drum brake
	Electric Brake	ABS&EBS (indicating the battery temperature exceeds 55°C,BMS start protection program,ABS/EBS fails.)
Charger	Input Voltage	100-120V/200-240V~
	Max. Output Voltage	58.1V2A
Tire	Type	9 inch tubeless tire,front & rear
	Tire Pressure	50 psi
	Material	Rubber
Suspension	Type	Front&rear spring and rubber suspension

***Disclaimer:** this is not a legal opinion or legal advice. The information provided herein (including in the App) is for your convenience and information purpose only. It is not intended to cover every piece of law and/or regulation that may be applicable to this product. DUALTRON explicitly hereby disclaims any and all warranty and/or representation, express or implied, related to completeness, accuracy, up-to-date of such information. DUALTRON reserves the right but not obligation to correct, implement and/or update the information. You shall use the information at your own risk. It is your sole responsibility to learn and understand any and all the law and/or regulation, requirements, prohibition, restriction and/or limitation imposed by either law, government authority, court, private party or the others that may apply to your use of this product.

***Theoretical Range:** tested while riding with a full battery, 75 kg load, 25°C, at the speed of 25 km/h on average on pavement.

***Typical Range:** tested while riding with a full battery, 75 kg load, 25°C, at the speed of 50 km/h on average on pavement. (Some of the factors that affect range include speed, number of starts and stops, ambient temperature, etc.)

***Max.Speed:** tested while riding with a full battery,75kg load,25°C,straight road on flat road with no wind. (Some environmental factors can affect max speed,un-even roads, crooked roads, temperature, wind, etc.)



Packing List

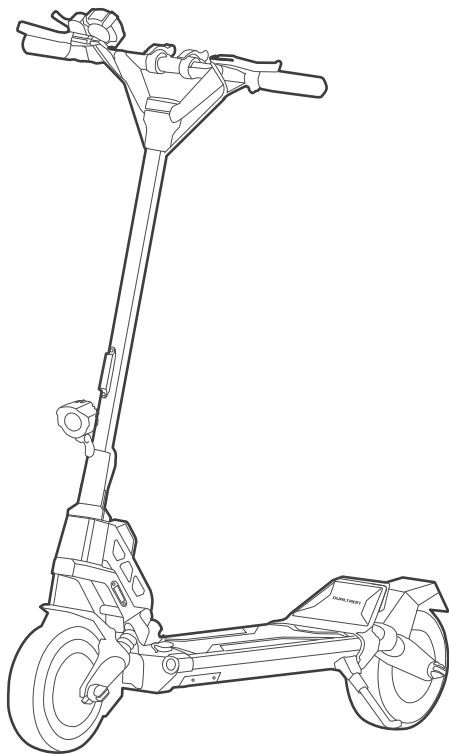

Accessories



Charger x1

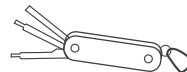

Multitool x 1



Manual



Screw Cap x 2



Assembly

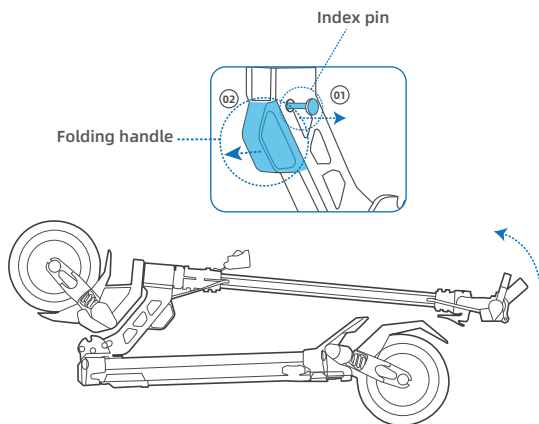

Scan the QR code to view
the handlebar installation

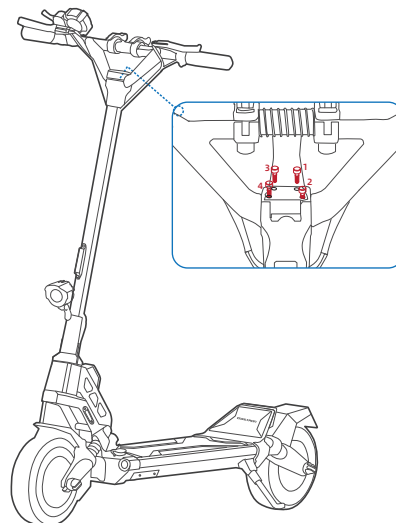

① Pull the index pin outward, then rotate it slightly to ensure a secure fit, the index pin will get stuck and the folding handle will work.

② Raise the steering tube and remember to reinsert the index pin to make this folding system more secure.

③ Loosen the 4 screws from handle stem, attach the folding handlebar body, and tighten the 4 screws back again. (When tightening the screw, the first step screw is 90% tight, you must tighten it diagonally, according to the order 1-4-2-3; the second step all screws are 100% tightened.)

Bluetooth Connection

APP Download Guide

Method 1

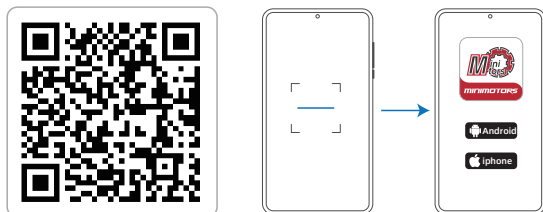

1. Scan the QR code to download the APP.
2. Choose the mobile phone system that suits you to install, and register / log in.

Method 2

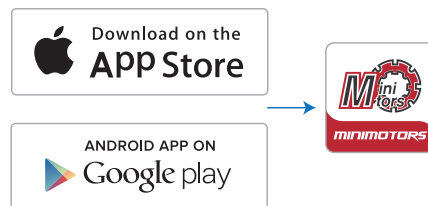

1. Search "DUALTRON" in the application and download it, and register / log in.

Pair the Bluetooth on the APP

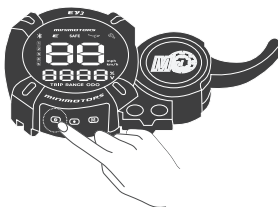

Power on the scooter.

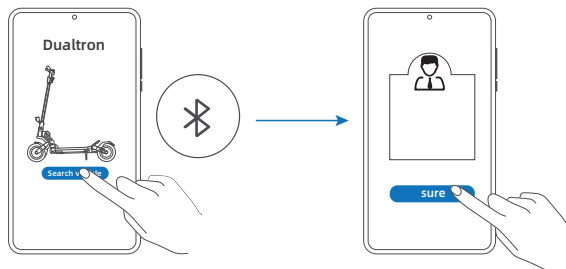

Click "Search vehicle" and pair with your scooter. * The scooter is connected to the Dualtron app when the Bluetooth symbol lights up.

Select "bind as owner".
(No one else can connect, only people authorized by you are allowed to connect. Authorizations are created on the app.)



How to Ride

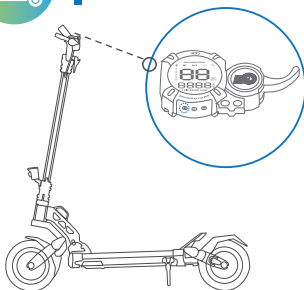

1. Power on the scooter and choose the speed mode. * Please choose the speed mode before riding! Note: Speed mode can be choose via the Dualtron app.



2. Stand on the footboard with one foot and push off with the other foot to start gliding. *Make sure you have disabled SAFE mode.(SAFE mode setting via Dualtron app.Deactivate safe mode by squeezing brake lever.)

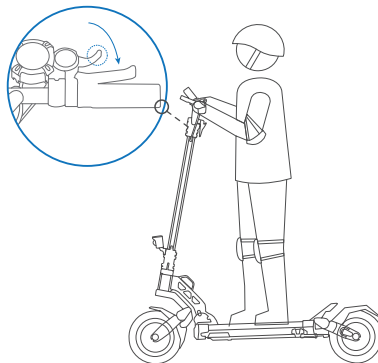

3. Put both feet on the footboard and stand stably. Pull the accelerator to speed up.

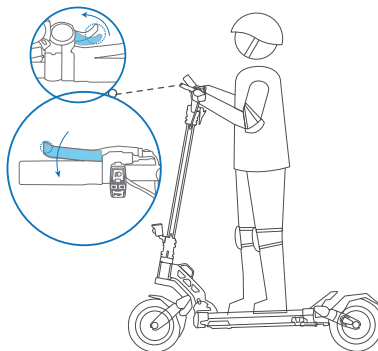

4. Slow down by releasing the accelerator and squeezing brake levers.

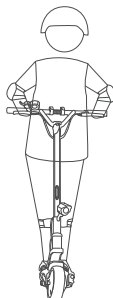

5. To turn, shift your body and turn the handlebar slightly.
* Please watch out for road conditions, sufficient turning space is required.



When hard braking, serious danger or injury may occur. Maintain a moderate speed and look out for potential hazards.



Folding

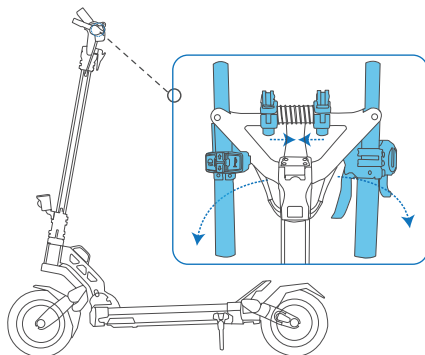

Release the QR lever of handlebar, move the locking slide inward and fold the handles.

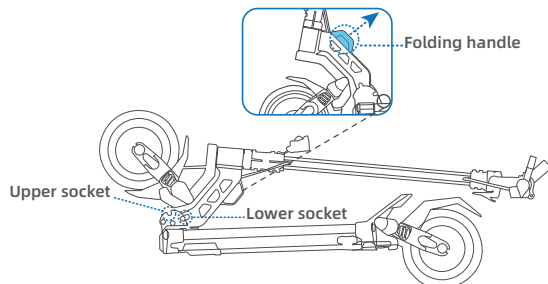

Pull the folding handle, folding plunger will come out of the upper socket and slip to lower socket.

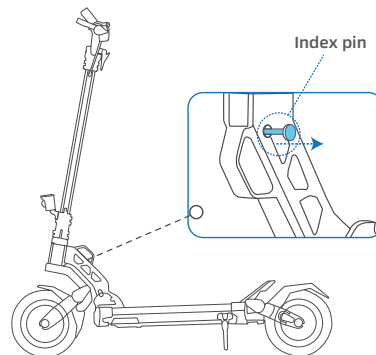

Pull the index pin outward, then turn it a little, the index pin will get stuck and the folding handle will work.

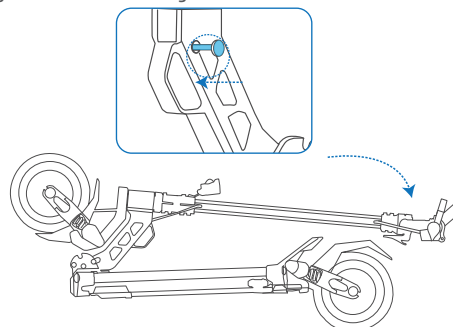

When the folding plunger gets stuck in lower socket and the folding handle resets in the stem headset, please remember to insert the index pin back to fix the folding system.

