

DUALTRON DOLPHIN

Personal Mobility

PRODUCT MANUAL

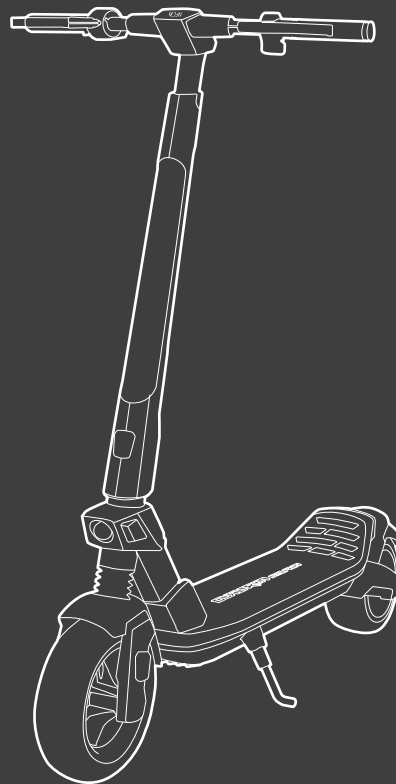

RECICLA
RECYCLE





Scan the QR code to download the latest user materials
and obtain the latest updates and safety instructions.

DUALTRON

The dream of electric technology.

Pictures for reference only, subject to our existing products.

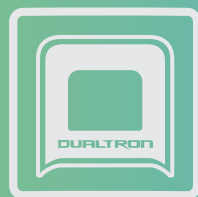



MINIMOTORS

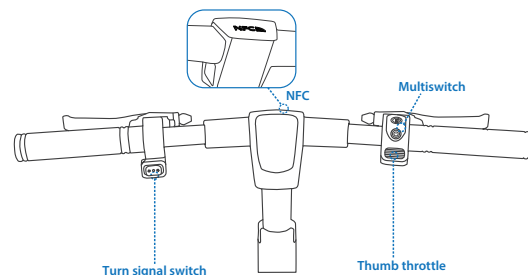
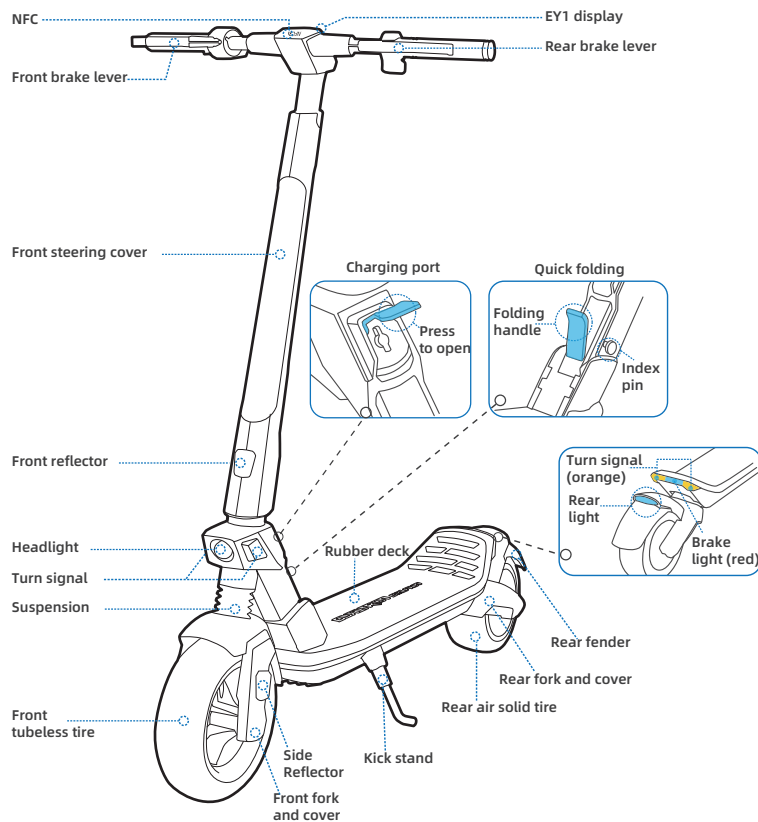

Diagram And Functions



Name	Function	Operation method
 Light button	Turn on/off light	Short press the light button, turn on/off the headlight, rear light. Long press the light button, the warning light work.
 Turn signal Button	Indicate turn signal	Click the button to indicate the turning signals.
 Power button	Power on/off & Switch gears	Long press the button to turn on/off the scooter. Short press the button to switch gears.
Thumb throttle	Speed up	Press the throttle to accelerate.
NFC area	Unlock the scooter	Hold the NFC card close to NFC area.



Specifications

	Item	Parameter			
Product	Model	Dualtron Dolphin			
Battery	Battery Capacity	36V7.8Ah	36V12Ah	36V14.4Ah (LG)	36V15Ah (Samsung)
	Range	25km	37km	45km	47km
	Charging Ambient Temperature	0 to 40°C (Battery temperature exceeds 55°C,BMS start protection program.)			
	Battery Management System	Over-heating, short circuit, over-current, over-discharge and over-charge protection			
Rider	Max. load	100kg			
	Recommended Age	16-60 years old			
	Required Height	3'11" -6'6" (120-200 cm)			
Display	Type	EY1 LED bluetooth display(Ability to connect to DUALTRON APP/NFC)			
Motor	Motor Type	BLDC Hub Motor			
	Nominal Power	450W			
Machine	Net Weight	Around 19.5kg	Around20kg	Around 21kg	
	Max. Slope	Around 26.8%[15°]			
	Drive System	Single motor drive			
	Speed	25km/h			
	Length × Width × Height	1140x590x1170mm			
	Folded: Length × Width × Height	1160x590x370mm			
	Wheelbase	Approx.900mm			
	Ground Clearance	120mm			
	Traversable Terrain	Asphalt/flat pavement; obstacles < 5 cm; gaps < 5 cm			
	Operating Temperature	-5 to 45°C			
	Storage Temperature	-20 to 50°C			



Specifications

Brake	Machine Brake	Front & rear drum brake+electric brake
	Electric Brake	ABS&EBS (Indicating the battery temperature exceeds 55°C,BMS start protection program,ABS/EBS fails.)
Charger	Input Voltage	100-120V/200-240V~
	Max. Output Voltage	41.5V1.5A
Tire	Type	Front tubeless tire(self-sealing tire is optional) Rear air solid tire
	Tire Pressure	40-45PSI
	Material	Rubber
Suspension	Type	Front coaxial dual spring suspension / Rear spring suspension

*Disclaimer: this is not a legal opinion or legal advice. The information provided herein (including in the App) is for your convenience and information purpose only. It is not intended to cover every piece of law and/or regulation that may be applicable to this product. DUALTRON explicitly hereby disclaims any and all warranty and/or representation, express or implied, related to completeness, accuracy, up-to-date of such information. DUALTRON reserves the right but not obligation to correct, implement and/or update the information. You shall use the information at your own risk. It is your sole responsibility to learn and understand any and all the law and/or regulation, requirements, prohibition, restriction and/or limitation imposed by either law, government authority, court, private party or the others that may apply to your use of this product.

*Theoretical Range: tested while riding with a full battery, 75 kg load, 25°C, at the speed of 25 km/h on average on pavement.

*Typical Range: tested while riding with a full battery, 75 kg load, 25°C, at the speed of 50 km/h on average on pavement. (Some of the factors that affect range include speed, number of starts and stops, ambient temperature, etc.)

*Max.Speed: tested while riding with a full battery, 75kg load, 25°C, straight road on flat road with no wind. (Some environmental factors can affect max speed, uneven roads, crooked roads, temperature, wind, etc.)



Packing List

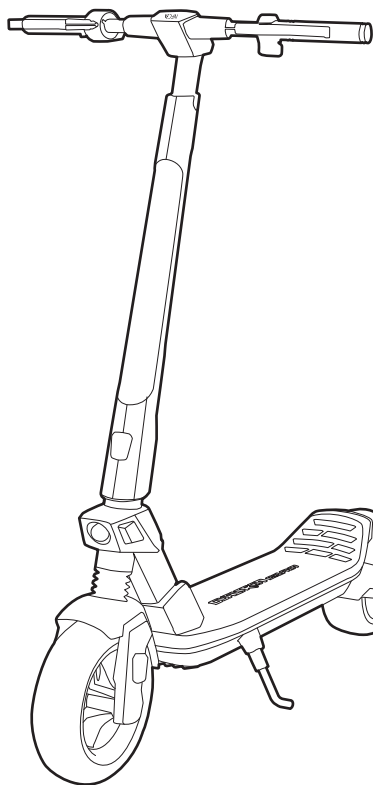

Accessories



Charger x1

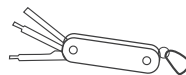

Multitool x 1

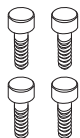

4 screws

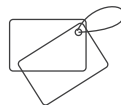

NFC card x 2



Manual



Assembly

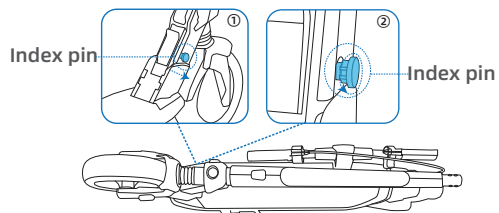

Pull the indexing pin outward to unlock the folding handle.



Assembly

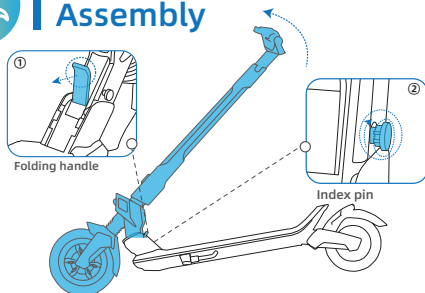

Pull the handle outward and lift the steering tube until fully extended.
At this time, confirm that the index pin is returned to lock the folding handle.

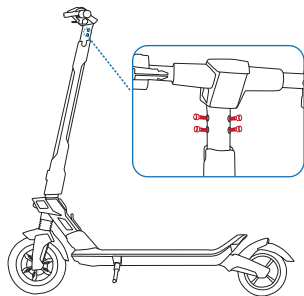

Attach all four screws without tightening them. Once all screws are attached, tighten them.

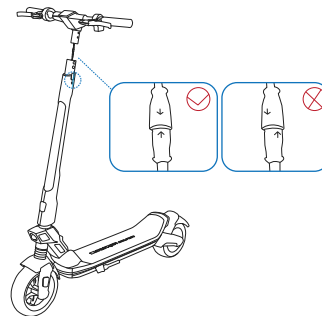

Connect the cables by aligning the arrows.

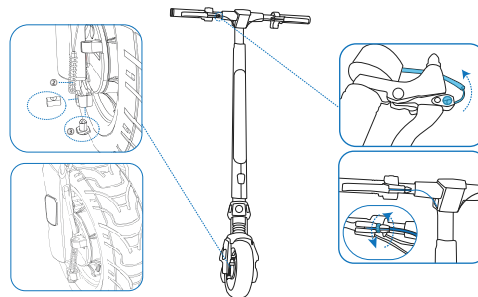

Adjust the brake cable to the appropriate position and tighten the screws.



Bluetooth Connection

APP Download Guide

Method 1

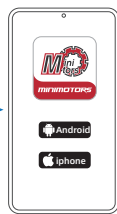
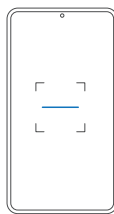

1. Scan the QR code to download the APP.
2. Choose the mobile phone system that suits you to install, and register / log in.

Method 2



1. Search "DUALTRON" in the application and download it, and register / log in.

Pair the Bluetooth on the APP

Step1: power on the scooter.

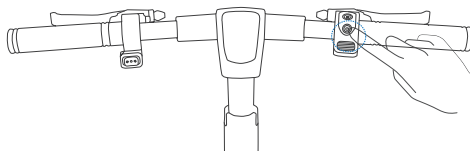

Step2: unlock scooter with NFC card.

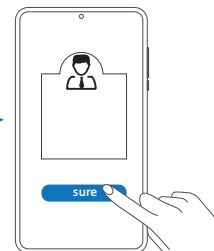
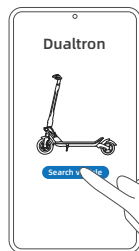
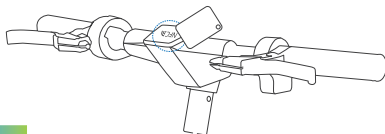

Click "Search vehicle" and pair with your scooter. * The scooter is connected to the Dualtron app when the Bluetooth symbol lights up.

Select "bind as owner". (No one else can connect, only people authorized by you are allowed to connect. Authorizations are created on the app.)



How to Ride

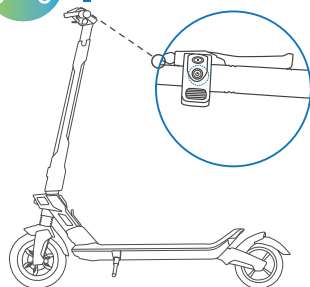

1. Power on the scooter and choose the speed mode. * Please choose the speed mode before riding! Note: Speed mode can be choose via the Dualtron app.

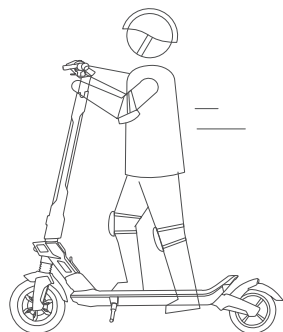

2. Stand on the footboard with one foot and push off with the other foot to start gliding. * Make sure you have disabled SAFE mode. (SAFE mode setting via Dualtron app. Deactivate safe mode by squeezing brake lever.)

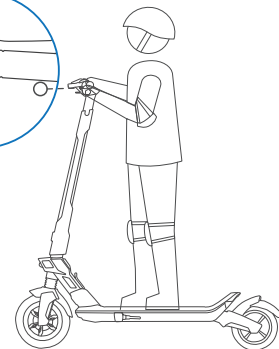
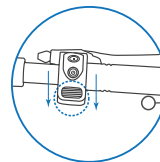

3. Put both feet on the footboard and stand stably. Press the accelerator to speed up.

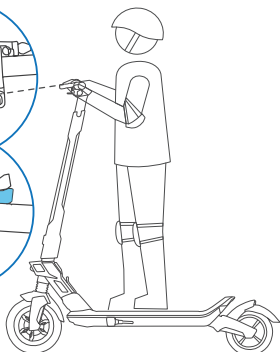
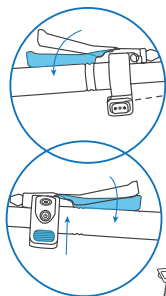

4. Slow down by releasing the accelerator and squeezing brake levers.

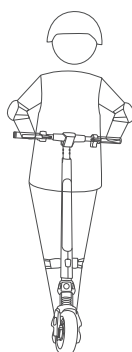

5. To turn, shift your body and turn the handlebar slightly. * Please watch out for road conditions, sufficient turning space is required.

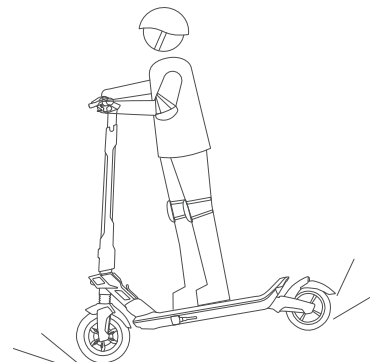

When hard braking, serious danger or injury may occur. Maintain a moderate speed and look out for potential hazards.



Folding

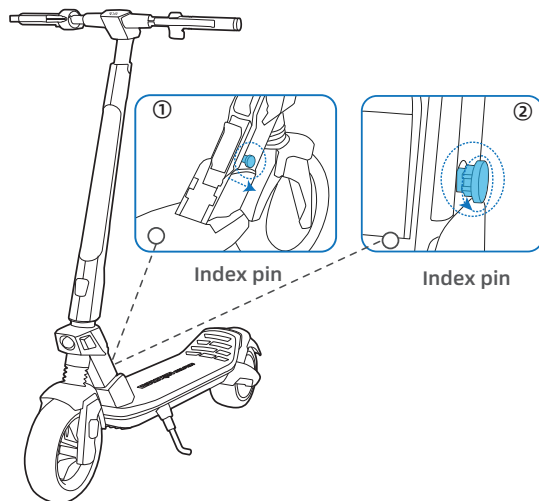

Unlock the folding handle by pulling the index pin outward.

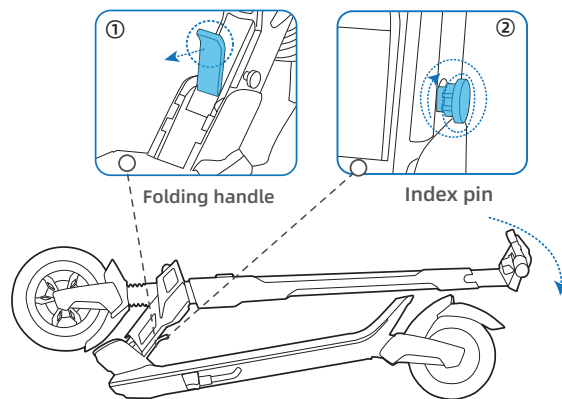

Pull the folding handle outward and slowly put steering tube down. Please remember to insert the index pin back to lock the folding.

